

# Parts for Ultima-TIG-Cut

Image

Item no.

Part description



40310522

Allen screw M3x10



75520001

Angle adjust unit



44520107

Arm for length Stop



44520101

Bearing Transmis. Hub Cut



40040610

Bolt stainless M6x10



44520109 Brass pin f. length stop



44520026 Bronze bearing Inward



44520027 Bronze bearing Outward



44520017 Bush for wheel



18480012 Cable relief black PG9

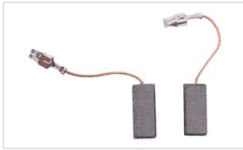

44520021 Carbon brush (2 pce)



44520045 Catch for Pickup

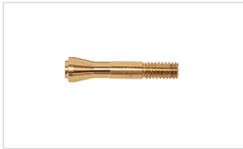

44525158 Clamp Cut. Ø0,8 mm

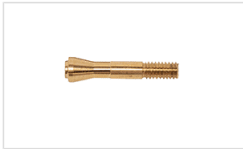

44525171 Clamp Cut. Ø1,0 mm

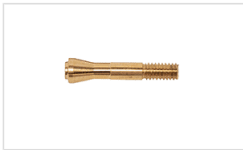

44525162 Clamp Cut. Ø1,6 mm

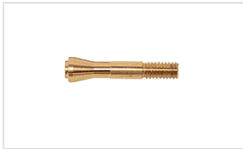

44525172 Clamp Cut. Ø2,0 mm

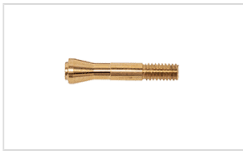

44525164

Clamp Cut. Ø2,4 mm



44525173

Clamp Cut. Ø3,0 mm



44525165

Clamp Cut. Ø3,2 mm



44525174

Clamp Cut. Ø4,0 mm

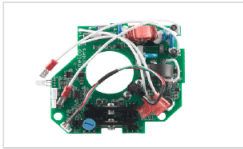

71618960

Control board UT 110V-230V



44494550

Cover for liquid tank W95/1-45-4



75520068

Cut arm



44520031

Cutter console



44490520

Cutting disc



44520060

Deburring Block



62189220

Degree scale



44520008 Degree scale bush



44529001 Desk console UT-CUT



44490513 Diamond disc 46 Grit Ultima-TIG



44490512 Diamond Disc Ultima-TIG



44491120 Drain plug for console W95/1-11-2



75522500 Drain/filling pipe



75494500 Dust Collector incl. liquid (UT + W95/1-45)



44492500 Elbow pipe 130mm W95/1-25



44511158 Electrode Clamp NX/UT Ø0,8 short



44510158 Electrode Clamp NX/UT, Ø0.8 mm



44510171 Electrode Clamp NX/UT, Ø1.0 mm



44511171 Electrode Clamp NX/UT, Ø1.0 mm, short



44510161 Electrode Clamp NX/UT, Ø1.2 mm



44510163 Electrode Clamp NX/UT, Ø1.5 mm



44510162 Electrode Clamp NX/UT, Ø1.6 mm



44511162 Electrode Clamp NX/UT, Ø1.6 mm, short



44510172 Electrode Clamp NX/UT, Ø2.0 mm



44511172 Electrode Clamp NX/UT, Ø2.0 mm, short



44510164 Electrode Clamp NX/UT, Ø2.4 mm



44511164 Electrode Clamp NX/UT, Ø2.4 mm, short



44510173 Electrode Clamp NX/UT, Ø3.0 mm



44511173 Electrode Clamp NX/UT, Ø3.0 mm, short



44510165

Electrode Clamp NX/UT, Ø3.2 mm



44511165

Electrode Clamp NX/UT, Ø3.2 mm, short



44510174

Electrode Clamp NX/UT, Ø4.0 mm



44511174

Electrode Clamp NX/UT, Ø4.0 mm, short



75520023

Electrode holder Ultima-TIG



44490901

Frame Black W95/1-92



44520126

Gasket for liquid insp. cover Cut



44492610

Grease nippel stopper SR1



75523020

Grinding console complete UT / UTC



44520000

Grinding console UT / UTC



75491301

Grinding Liquid Con. 250 ml



75491300

Grinding liquid conc. 3 l for 60 l



75491305

Grinding Liquid conc. 4,5 L for 90 liters



75491200

Grinding liquid Neutra 250 ml W95/1-12



75494000

Grinding liquid, 5 litre W95/1-40



44520047

Guide f. electrode holder



40310520

Guide Screw for Arm



44520034

Handle Cut



44520020

Handle for electrode holder



44520070

Hub for arm Cut



44520125

Inspec. cover f. liquid level



44510290

Inspection cover NX



75520010 Interface modul UT110/220



44520048 Locknut



44520007 Metal strip stainless



75500168 Module Cutter



44529004 Motor 230V UT CUT



44520215 Motor cover



44491711 Mounting screw



41110403 Nut M4



41110605 Nut M6



44470211 O-ring 10x1 (NBR70) for pickup



44470216 O-ring f. shaft ø8x1





44470312 O-ring Ø12x2.5 mm



44470329 O-ring W95/1-11-3



44520040 Outer Bearing BF 101

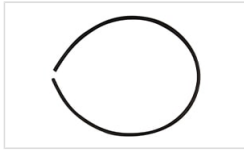

44520009 Packing ring for insp.cover

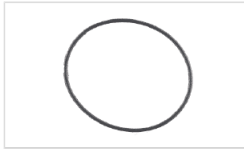

44520010 Packing ring for rear plate



75500170 Pickup



75520021 Pickup release



44490522 Plastic cogwheel for spindle



44490521 Plastic disc



44490700 Plastic Inspection Cover W95/1-07

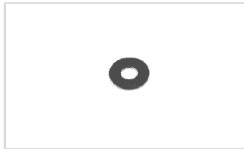

41512304 Plate disc Rustproof ø4



40310404 Pointed screw M4x6



40310610 Pointed screw M6x10



40310406 Pointed screw M6x6

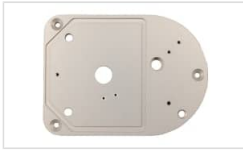

44520206 Rear Plate Cutter console UTC110/220



44520005 Rear Plate Grinding Console



40210620 Recessed screw M6x20



40320410 Retaining screw M4x10



44520106 Rod for Length stop



44470029 Rubber lead-in ring ø9 mm



44470124 Rubber pack (membrane), Ø25 mm



44520016 Rubberplate f. motor cover



44493210 Screw BT16P M4x16



44520024 Screw for stick-out



40110511 Screw M4x12



40110406 Screw M4x6



44496525 Screw M5 Lefthand Stainless



40040670 Screw M6x70



44520038 Shaft for arm



44520019 Space piece for motor (4 pcs)



44520036 Space ring for spring

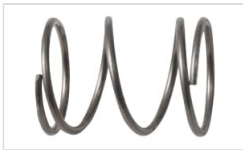

44520037 Spring



44520028 Spring f. stick-out



44520023

Stainless steel barrel for el. holder



44520130

Stick-out bolt cut



44529002

Stiffening plate UT+CUT



44520022

Stretching screw



17110027

Switch 2pol-4pin



44491225

Tap for 5 L canister



44492600

Tapping hose W95/1-26



44520058

Threaded rod



44520004

Tightening screw



75520049

Tip collector Ø 2,5



75520050

Tip collector Ø 4,2



41711106 Tooth lock washer ø6



40310521 Torx screw M3x12

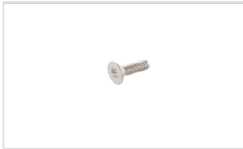

40310524 Torx screw M4x12 DIN 7991 UH



40310523 Torx screw M4x16



44520103 Transmission cogwheel



44520202 Transmission hub UTC110/220



41530530 U-wheel UT



44520014 Valve flap UT 20x20x1 2xM3



44520104 Washer f. trans. cogwheel



44490523 Washer for gear



74673520 Wire 1,5x200 yellow/green

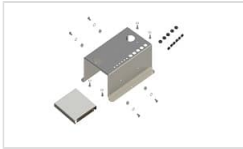

88897900

Working table Ultima-TIG-CUT



Industrivej 3  
9690 Fjerritslev  
Denmark

Tel.: (+45) 96 50 62 33  
[info@inelco-grinders.com](mailto:info@inelco-grinders.com)