

Exploded-view drawings of spare parts to Neutrix

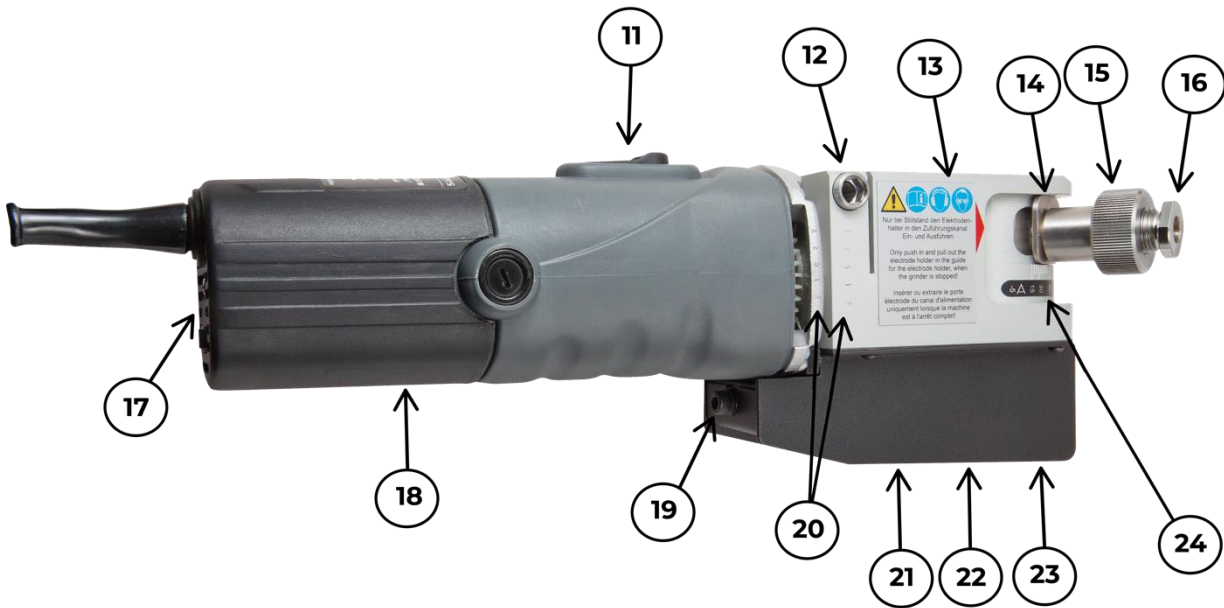

**Neutrix case**

| Pos. | Item No. | Description                        |
|------|----------|------------------------------------|
| 1    | 88896022 | Neutrix Tungsten Grinder 230V-50Hz |
| 2    | 44510050 | Electrode holder NX                |
|      | 44510164 | Electrode Clamp NX/UT, Ø2.4 mm     |
| 3    | 44510440 | Allen key 2 mm                     |
|      | 44510430 | Allen key 4 mm                     |
| 4    | 44510400 | Key 13 & 17 mm                     |
|      | 44510410 | Key 14 & 17 mm                     |
| 5    | 44510162 | Electrode Clamp NX/UT, Ø1.6 mm     |
|      | 44510165 | Electrode Clamp NX/UT, Ø3.2 mm     |
| 6    | 44510328 | Wool brush                         |
| 7    | 99140003 | Plastic bag 120x180 mm             |
| 8    | 44510450 | Grease FDA-G2                      |
| 9    | 44510291 | Suction disc                       |
| 10   | 44510390 | Case with foam NX                  |



### Neutrix structure and description 1

| Pos. | Item No.    | Description                         |
|------|-------------|-------------------------------------|
| 11   | 44510011    | Switch NX - 850W                    |
| 12   | 44510150    | Allen screw for clamping of head NX |
| 13   | 44510020    | Grinding console NX                 |
| 14   | 44510200    | Eccentric plate NX                  |
| 15   | 44510220    | Tightening screw NX                 |
| 16   | 44510140    | Guide for electrode holder NX       |
| 17   | 44510025    | Speed regulator Neutrix 850W        |
| 18   | 44510008    | Motor Wag 40-850W 230V-50Hz         |
| 19   | 44510253    | Allen screw M5x12                   |
| 20   | Machine no. |                                     |
| 21   | 44510260    | Filter box NX                       |
| 22   | 44510252    | Filter grille NX                    |
| 23   | 44510250    | Filter house NX                     |
| 24   | 44510360    | Grinding angle                      |

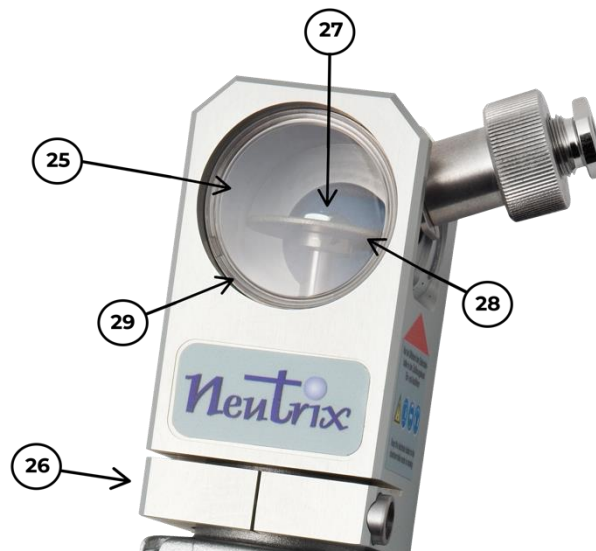

## Neutrix structure and description 2

| Pos. | Item No. | Description                        |
|------|----------|------------------------------------|
| 25   | 44510290 | Inspection cover NX                |
| 26   | 44510190 | Allen screw for stick-out CH M5x30 |
| 27   | 44510370 | Counter nut M8 NX                  |
| 28   | 44510030 | Diamond disc Ø40 mm NX             |
| 29   | 44510100 | Grinding chamber NX                |

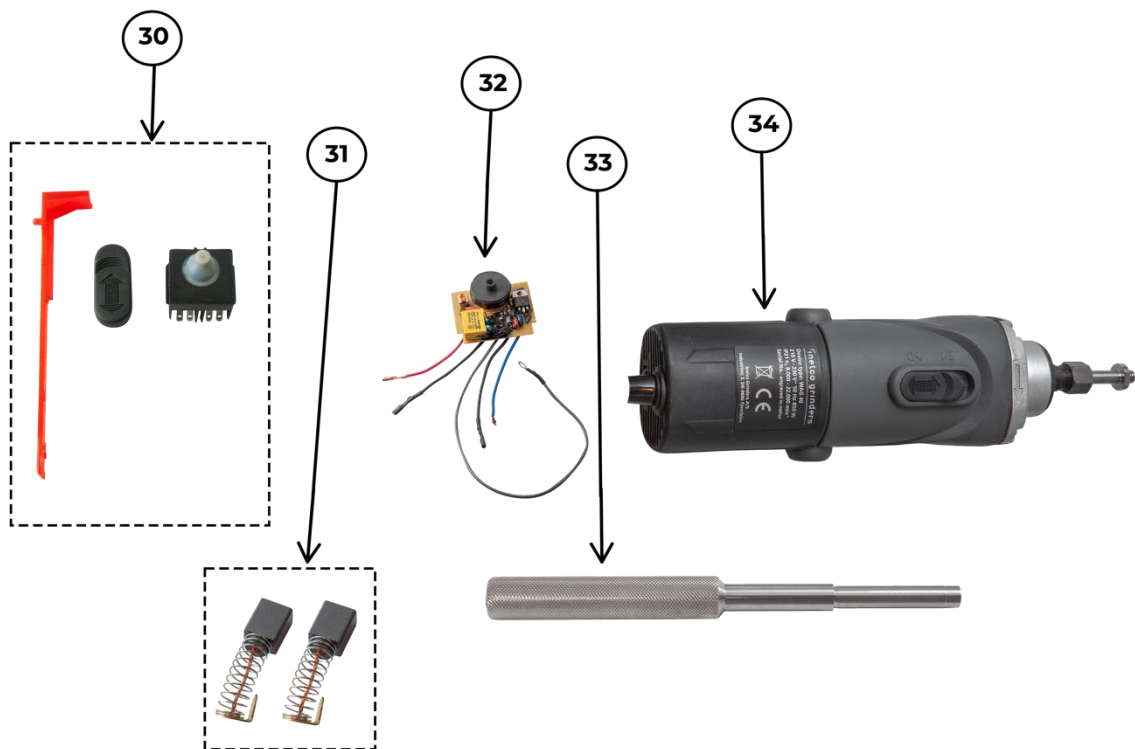

## Neutrix spare parts

| Pos. | Item No. | Description                           |
|------|----------|---------------------------------------|
| 30   | 44510011 | Switch NX - 850W                      |
| 31   | 44510019 | Coal (2 pcs.) for Neutrix (850W) 2014 |
| 32   | 44510025 | Speed regulator Neutrix 850W          |
| 33   | 44510050 | Electrode holder NX                   |
| 34   | 44510008 | Motor Wag 40-850W 230V-50Hz           |

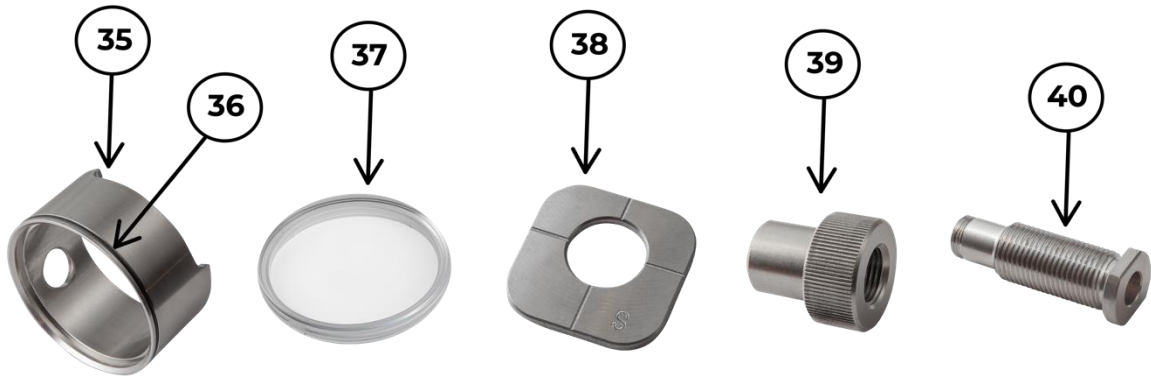

### Grinding chamber

| Pos. | Item No. | Description                   |
|------|----------|-------------------------------|
| 35   | 44510100 | Grinding chamber NX           |
| 36   | 44510481 | O-Ring Ø48x1 mm               |
| 37   | 44510290 | Inspection cover NX           |
| 38   | 44510200 | Eccentric plate NX            |
| 39   | 44510220 | Tightening screw NX           |
| 40   | 44510140 | Guide for electrode holder NX |

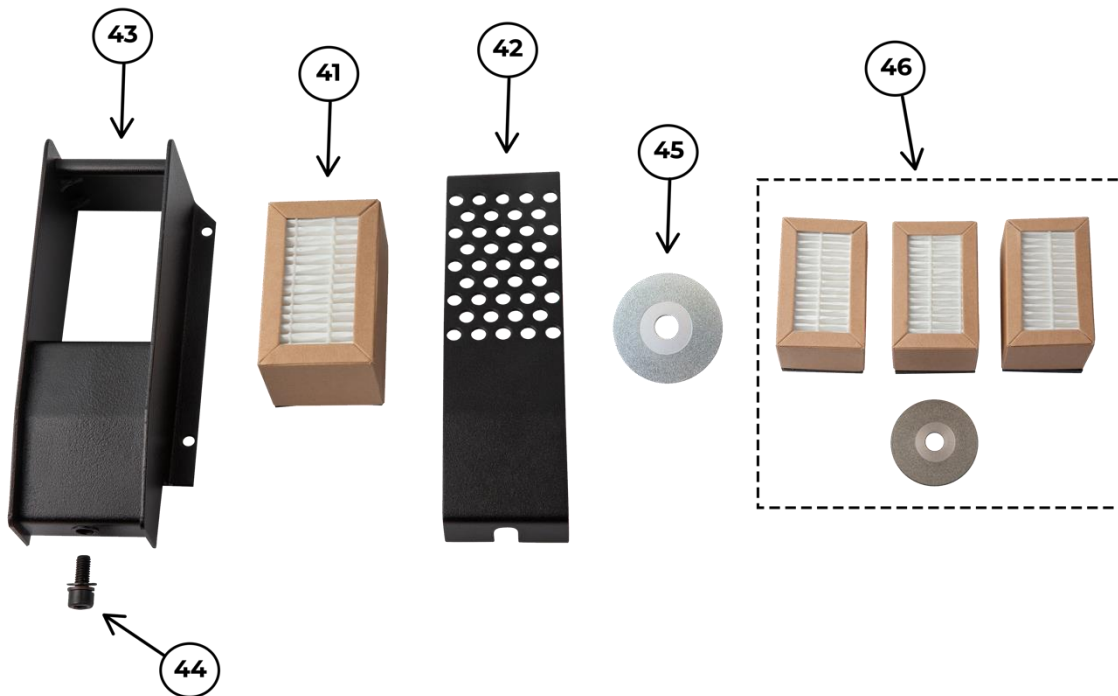

### Filter and accessories

| Pos. | Item No. | Description               |
|------|----------|---------------------------|
| 41   | 44510260 | Filter box NX             |
| 42   | 44510252 | Filter grille NX          |
| 43   | 44510250 | Filter house NX           |
| 44   | 44510253 | Allen screw M5x12         |
| 45   | 44510030 | Diamond disc Ø40 mm NX    |
| 46   | 75505110 | Grinding disc kit Neutrix |

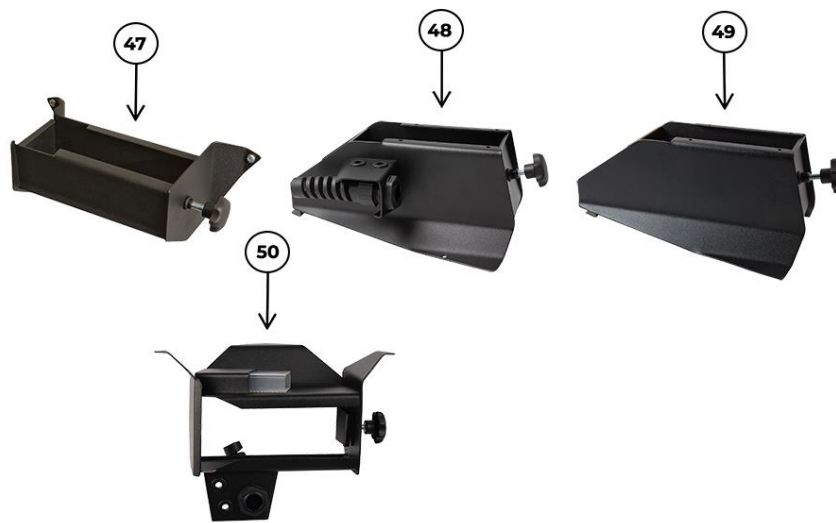

### Neutrix mount

| Pos. | Item No. | Description                 |
|------|----------|-----------------------------|
| 47   | 44510280 | Wall mount NX               |
| 48   | 44510275 | Table mount w/toolholder NX |
| 49   | 44510270 | Table mount NX              |
| 50   | 44510285 | Wall mount NX w/toolholder  |